

7. How to Log out/Clock out

Clock out & Log out

Similar to **Clock in**, after finishing your shift, you should click on the **Clock Out** button and Log out. If you Log out without clocking out, it will automatically register your shift as finished.

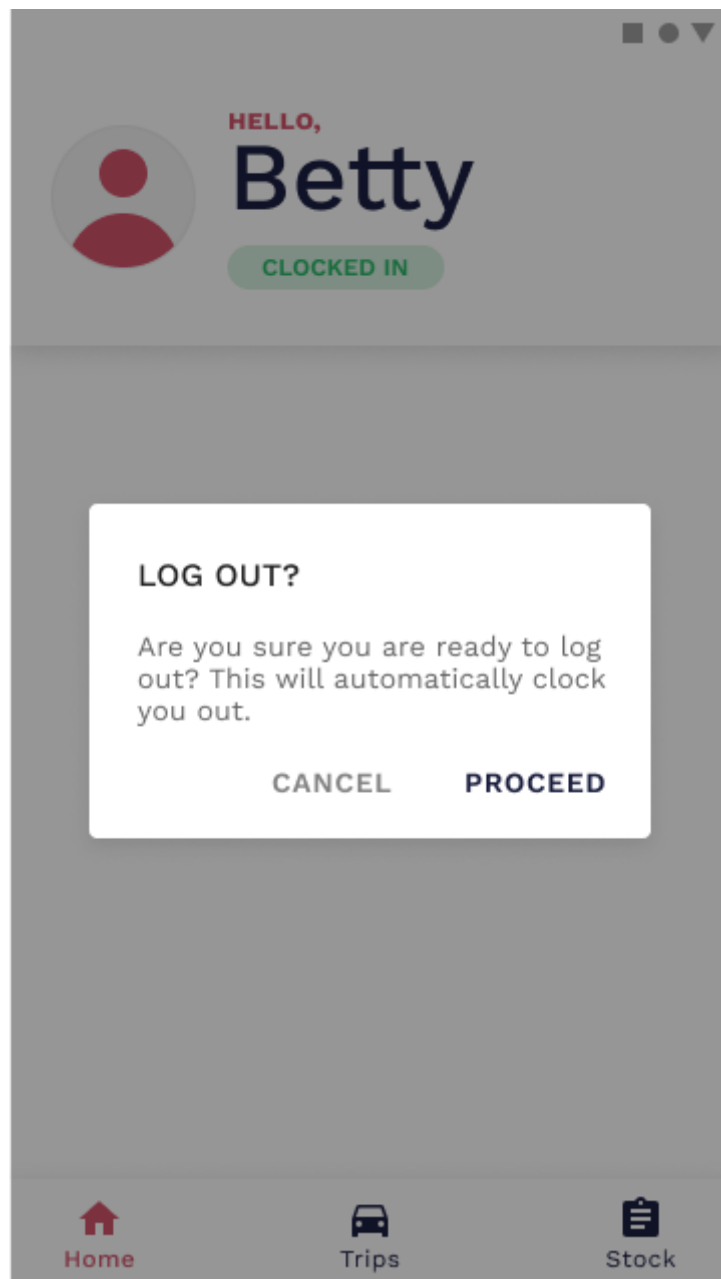

Video tutorial

Revision #3

Created 6 September 2023 08:26:00 by Adolfo Cabrera

Updated 14 September 2023 15:02:33 by Adolfo Cabrera